



GREETINGS TEXAS SKI RANGERS!!

It's time for the Annual Meeting and Challenge Cup (AMCC) also known as Mini-Summit. During the week of January 12 – 19, 2008 we will converge on Breckenridge, CO. This year's event promises to be one to remember as we will be celebrating 35 years of skiing as a brotherhood!!

This packet contains information on NBS registration, ski school, equipment rental, and lodging. The last page of this packet is the trip application. Please fill it out in its entirety. If you are unsure about a section or do not need that service, please note that in some manner on the trip app (either TBD or NA). This packet is also available online at www.texasskirangers.org under trips. If this packet does not answer all of your questions, please feel free to email me at tsrbreck@gmail.com. Remember that your TSR membership must be current for 2007-2008.

See you on the Mountain,
Keena Harris
AMCC 2008 Trip Leader

REGISTRATION

This year each registration will include a **Breck35** pass. This pass is a one stop opportunity to have access to NBS events, secure significant discount opportunities on the mountain and in the Village of Breckenridge, as well as provide a phenomenal package for skiing/riding at some of the best resorts the Colorado Rockies have to offer.

NOTE: The Breck35 pass is only available to those staying in NBS housing. There will be an exception for Time-share owners and homeowners and their guests (appropriate documentation is required – more on this soon).

All Breck35 passes entitle you to:

- Special 35th Anniversary gift, access to NBS happy hours, parties, and special events
- A personal activity pass that gets you discounts at bars, restaurants, rental and retail shops both on the mountain and in the village

The **Breck35 pass for Alpine Skiers** entitles you to:

- Up to five (5) days of skiing at Breckenridge, Keystone, Arapahoe Basin (A-Basin), Vail, and Beaver Creek

The **Breck35 pass for Nordic Skiers** entitles you to:

- Up to five (5) days of Nordic skiing at Breckenridge Nordic Center and Gold Run Nordic Center
- Pass is also good at the Frisco Nordic Center

The **Breck35 pass for Non-Skiers/First Time Skiers** entitles you to:

- An opportunity to try skiing for the first time - one free beginner lesson & lift ticket

The **Senior Breck35 pass** (ages 70 & up) entitles you to:

- Up to five (5) days of skiing at Breckenridge, Keystone, Arapahoe Basin (A-Basin), Vail, and Beaver Creek

The **Youth Breck35 pass** (ages 5-12) & (ages 13-18) entitles you to:

- Includes registration for the 2008 AMCC, which will entitle you to a special 35th Anniversary gift, and access to all youth activities
- Up to five (5) days of skiing at Breckenridge, Keystone, A-Basin, Vail and Beaver Creek

NOTE: The activity pass cannot be used on any days during Jan. 19-21, 2008. The NBS can purchase lift tickets at Breckenridge for individuals that would like to stay over the MLK weekend for \$59 per day, provided that the NBS has a group of a least 20 people. Let me know if you are interested.

REGISTRATION PRICING

Breck35 (Registration) Pass for **Alpine** Skiers

Registration	Amount	Due Date	Initial Payment Required	Balance due date Nov 16th
Early	\$425	September 7	\$215	\$210
Regular	\$475	October 17	\$240	\$235
Late	\$500	November 16	\$250	\$250
Onsite	\$525	NA	NA	NA

Breck35 (Registration) Pass for **Nordic** Skiers

Registration	Amount	Due Date	Initial Payment Required	Balance due date Nov 16th
Early	\$340	September 7 th	\$215	\$210
Regular	\$390	October 17 th	\$240	\$235
Late	\$415	November 16 th	\$250	\$250
Onsite	NA	NA	NA	NA

Breck35 (Registration) Pass for **Non-Skiers/First Time** Skiers

Registration	Amount	Due Date	Initial Payment Required	Balance due date Nov 16th
Early	\$305	September 7 th	\$155	\$150
Regular	\$355	October 17 th	\$180	\$175
Late	\$380	November 16 th	\$190	\$190
Onsite	NA	NA	NA	NA

The following registrations are not subject to the same deadlines as the above:

Senior Breck35 pass (Ages: 70+) - \$350

Youth Breck35 pass:

Ages 5 - 12 - \$177

Ages 13 - 18 - \$270

SKI SCHOOL

NBS registered participants will receive a 20% discount on ski school lessons. You must present your Breck35 pass and registration I.D. Check www.breckenridge.com for ski school offerings.

NURSERY SKI SCHOOL PROGRAMS

Kinderhut - 970.453.0379

Located adjacent to Beaver Run Resort on Peak 9

Average Prices:

\$125 Full Day (8:15am – 4:15pm)

\$75 half day (8:15am – 12:00pm or 12:30pm – 4:15pm)

- 2 or 3 day package \$115 per day
- 4 or 5 day package \$110 per day
- 6 or more day package \$100 per day

Mountain Sitters - 970.477.0010 or 970.477.0024

All Sitters are 21+ years & CPR Certified

\$18hr/child

\$1/hr each additional child

Resort Sitters - 970.547.4445

<http://www.summit.resortsitters.com/>

EQUIPMENT RENTALS

NBS registered participants receive group discounts on rentals. Present your activity pass and registration identification to receive the group discounts. Costs from various businesses are outlined below:

Black Tie Ski Rentals of Breckenridge - www.blacktieskis.com

* All packages include skis, boots, and poles.

Developmental	33.00
High Performance	40.00
Demo	46.00
Demo/Ski only	42.00
Develop. Snowboard	33.00
HP Snowboard	40.00
Jr. Ski	21.00
Jr. Snowboard	21.00
Helmets	7.00

*Ski only reduces any package rate by \$4.00 per day.

*Demo packages include skis from the following manufacturers: K2, Rossignol, Volkl, Solomon, and Atomic

Resort Quest Ski & Sport - www.resortquestskiandsport.com

(Does not include 8.275% tax)

A Damage Waiver can be added for \$1/day

Children's skis (Less than 90 lbs. w/sz. 6 shoe or smaller)	\$5.00
Sport Shape Skis	\$10.00
Performance Shape Skis	\$15.00
Demo Skis	\$23.00
Children's Boards	\$10.00
Snowboards	\$15.00
Demo Snowboards	\$23.00
Mini-skis	\$10.00

EQUIPMENT RENTALS cont.

Blue River Sports – www.blueriversports.com

The rate for our Recreation package is:

2-4 day rental - \$18.45/day including tax

5 plus day rental - \$14.76/day including tax (no free days)

The rate for our Silver Snowboard package is:

2-4 day rental - \$24.60/day including tax

5 plus day rental - \$19.63/day including tax (no free days)

*These rates are based on advance reservation. All our skis are shaped skis.
For package descriptions please see our web site.

Breeze Ski/Max Snowboard Rentals – www.skirentals.com

Recreation (Basic Ski Package)	\$15.38	Junior Skis	\$8.20
Deluxe (New for this Season)	\$18.45	Junior Performance	\$11.28
Performance	\$23.58		
Specialty	\$30.75		
Silver Snowboard (Basic)	\$21.53	Junior Snowboard	\$13.33
Gold Snowboard (Intermediate)	\$26.65		
Titanium (Specialty)	\$30.75		

*Junior packages are for children 90 pounds or less with a shoe size of 6 or less.

Breckenridge Sports – www.rentskis.com

Sport Shaped Ski Pkg. - \$14.99 per day

Performance Shaped Pkg.- \$22.99 per day

Demo Shaped Pkg. - \$26.99 per day

Snowboard Pkg.- \$32.99 per day

Jr. Shaped Pkg.- \$11.99 per day

Jr. Snowboard Pkg. - \$14.99 per day

Snowblade Pkg. - \$25.99 per day

LODGING

Beaver Run Resort is a ski-in/ski-out property located next to the Beaver Run Super Chair and three blocks from Main Street.



- Two Queen Beds
- Complete Kitchen
- Spa Tub
- Fireplace
- Private Balcony

Four people per condo – \$725 per person

www.BeaverRun.com

Cimarron Condominiums are a short stroll to both to the Peak 9 lift and Main Street.

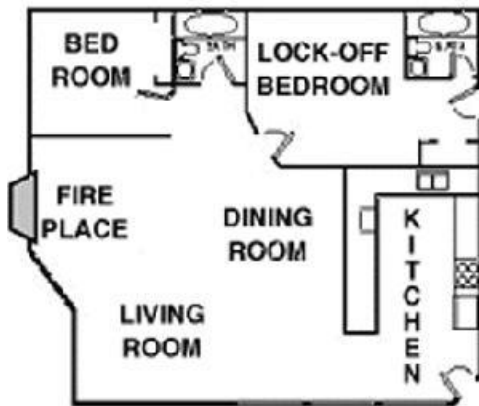

- 2 Bedroom / 2 Bath
- Fireplace
- Garage
- Hot Tub (Common Area)
- Kitchen
- Pool (Common Area)
- Washer/Dryer (common)

Four People: \$351 per person

www.ResortQuest.com



**NBS AMCC 2008 (Mini-Summit) @ Breckenridge, CO
January 12-19, 2008**



Trip Application

REGISTRANT INFORMATION

Name: _____
 Address: _____ DOB: _____
 Phone: (Home): _____ (Cell): _____
 Email: _____ T-shirt Size: S M L XL XXL XXXL
 Roommate(s): _____ Smoker: Y N

THE FOLLOWING INFORMATION WILL ASSIST YOU IN DETERMINING YOUR TOTAL TRIP COST

Administration Fee					(Required and Non-Refundable)		25.00
NBS AMCC Registration					(Non-refundable unless transferred)		
Youth Breck35 (5-12) - \$177		Senior Breck35 (70+) - \$350					
Youth Breck35 (13-19) - \$270							
The above prices are not subject to the early or regular deadlines - full amount must be paid by Nov. 16 th .							
Deadline	Breck35 Alpine Skier	Breck35 Nordic Skier	Nordic/ Alpine Initial Payment	Breck35 Non-Skier/ First Time Skier	Non-Skier/ First Time Initial Payment		
Early - September 7	\$425	\$340	\$215	\$305	\$155		
Regular - October 17	\$475	\$390	\$240	\$355	\$180		
Late - November 16	\$500	\$415	\$250	\$380	\$190		
Full Balance due by Nov. 16th							
Airfare - \$265 (225 + 40 deposit, price not guaranteed until ticketed)				\$40 deposit due NOW (to be refunded)			
Departure: AA1149 DFW to DEN 10:25a 11:30a				Return: AA2250 DEN to DFW 3:45p 6:45p			
Bus Transportation - \$50 Round trip between Denver Int'l Airport & Breckenridge (\$25 due now)							
***This includes a one hour stop at the grocery store! ***							
Lodging Prices include taxes & luggage handling fee					\$100 due NOW (non refundable)		
Half of lodging balance due - Oct. 6					75% penalty before Nov.13		
Full balance due - Nov. 16					No refund after Nov. 14		
Beaver Run (Ski In/Ski Out) - Yippie!!					Cimarron Condominiums		
2 bedroom / 2 bath					2 bedroom / 2 bath		
www.BeaverRun.com					www.ResortQuest.com		
Four People: \$725 per person per wk					Four People: \$351 per person per wk		
Total Cost (all prices are subject to change)							

PAYMENT REMITTANCE

Please make checks/money orders payable to **TEXAS SKI RANGERS**

Mail forms/payments to: **Keena Harris**
14400 Montfort Dr. # 504
Dallas, TX 75254

Fax form to: **682-605-8807**

